

DUAL DRIVE ELITE POINT DRIVER



Operating Instructions

Loading Points

1. Press release button
2. Pull up cover
3. Install point strips with point facing forward

NOTE: Make sure points are inserted down into nose piece.

4. Slide cover closed (**Fig. 1**)

Operation

1. Hold outside of frame
2. Press driver nose against inside frame
3. Keep drive flat on material - **DO NOT LIFT OR ANGLE**
4. Squeeze trigger to insert point
5. Space points 6" apart, 3" from corners (**Fig. 2**)

Adjust Point Depth

1. Turn adjustment screw to increase tension for hardwoods or decrease tension for softwoods. (**Fig. 3**)

Identification

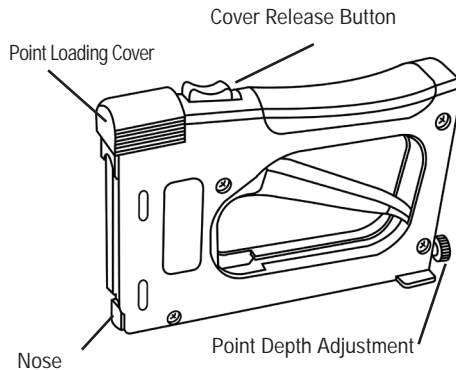

Point Jammed

1. Remove points
2. Remove nose screw and nut
3. Remove nose piece and discard jammed point (**Fig. 4**)

Replacement Points

Use only authentic Logan Points
 F53 - Flex (600) F54 - Rigid (600)
 F55 - Flex (2500) F56 - Rigid (2500)

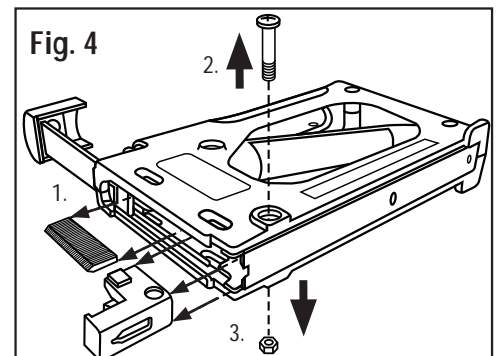
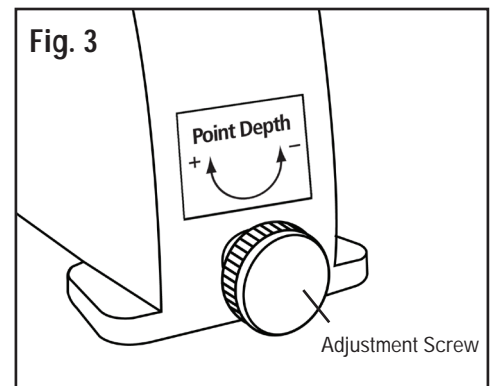
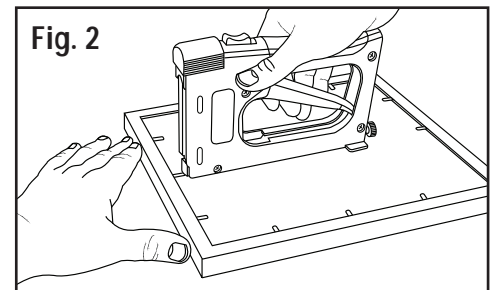
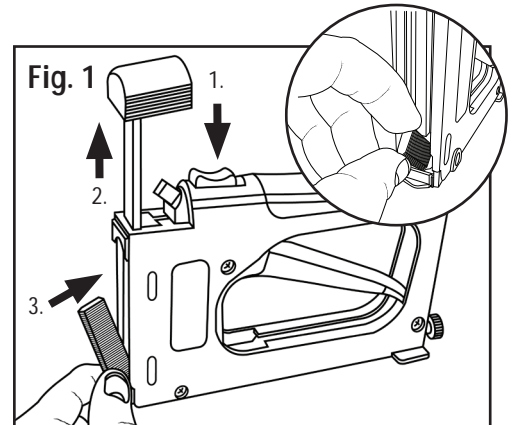

Troubleshooting

IF GUN JAMS & NO LONGER FIRES POINTS

- Keep 1" or higher stack of points in gun at all times
- Make sure you are using authentic Logan rigid or flexible points (F53, F54, F55, F56).
- Make sure points are loaded and seated correctly. Try removing and re-loading the point strip.
- To remove a point jammed in the nose piece, reference the instructions to remove the nose piece, clear it and re-install it.
- If point does not leave the gun, try reducing or tightening tension.
- Check to see that main body screws holding two halves of the tool together are not loose. If necessary, re-tighten with Phillips screwdriver.

IF THE POINT BENDS

- If flexible inserts are bending or not staying in the wood, try increasing the tension or switch to rigid points.
- Try reducing the tension if handle is hard to pull.

